

ATLAS

by Veil

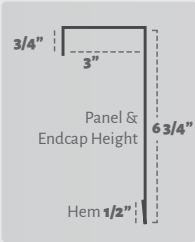

Finish
Powder coat
semi-gloss textured
white

Eco-friendly
Made from recycled
aluminum

Installation
Slips over existing
baseboard heater
backplate. No tools
necessary.

Material
16-gauge
aluminum
Accessories
16-gauge
aluminum

Rust Free
Guaranteed not to
rust as long as you
own them

Ideal For
Hydronic, hot
water and electric
baseboard heaters



8 Ft.

7 Ft.

6 Ft.

5 Ft.

4 Ft.

3 Ft.

2 Ft.

Retrofit Guide

One panel size fits over 95% of existing baseboard heaters!



Floor to the top of the
existing back plate.

Between 7 1/2" and 9"

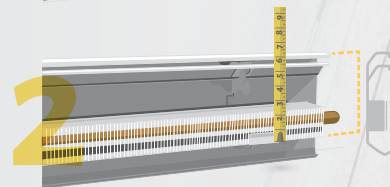

Bottom of heating
element to the top of
the existing back plate.

Between 5" and 6 3/4"

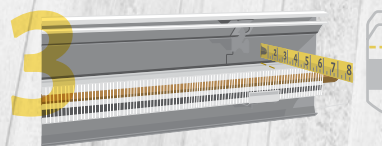

Back plate to the front
of the front of the
heating element.

Less than 3"

Accessories

- 1 Closed End Cap
- 2 Open End Cap
- 3 Zero Clearance End Cap
- 4 Coupler
- 5 90° Inside Corner Piece
- 6 90° Outside Corner Piece
- 7 135° Inside Corner Piece
- 8 135° Outside Corner Piece

